

Highlights:

- Stores up to 32 units of 19" Equipment
- Punched square holes for use with snap-in cage nuts
- in depth adjustable 19" profiles (max 1015 mm)
- Easy assembly in 10 minutes
- Unrestricted air flow due to open-frame design
- Ships as flat-down package
- Can carry a max load of 450 kg

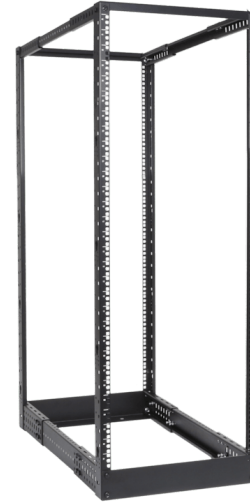

The DPR932 is a professional and solid constructed 4-post open-frame rack for 19" equipment compliant to ANSI/EIA RS-310D, DIN41491 and IEC60297 standards. It offers a sturdy and low-cost solution, suitable for installing up to 32 units of 19" equipment. The open frame construction is made of 2.0 mm thick steel and finished in a black (RAL9004) powder coating with fine structure and printed unit measurement indicators. Adjustable vertical supports allow in depth adjustment within a range of 56 to 102 cm while the base angle profiles can be mounted outwards for increased stability or inwards for conserve floor space. Delivery in a flat-down package allows easy transportation of the rack to any installation location, while the simple structure allows assembly by a single person in a record-breaking time.

Product Features:

Unit height	32 HE
Max. usable depth	550 ~ 1015 mm
Max. load	450 kg
Dimensions	514 x 1562 x 560 ~ 1020 mm (W x H x D)
Weight	20.530 kg
Colours	Black (RAL9004)
Accessories	Included
	1 set Assembly hardware
	24 x Cage nuts + screws
	Optional
	KS600 - M6 x 16 mm bolt DIN7985 Black
	KM600 - M6 Cage nuts

Variants:

- DPR932/B - Black version

Architects' and Engineers' Specifications:

The rack shall be a 19" four post open frame rack type with following dimensions: height 1562 mm, width 514 mm and depth adjustable between 560 ~ 1020 mm with 32 usable rackspaces and compliant to ANSI/EIA RS-310D, DIN41491 and IEC60297 standards. The rack shall ship unassembled as a flat-down package and provide a static load capacity of 450 kg. The frame of the rack shall be constructed out of cold rolled steel with a thickness of 2.0 mm, while punched square holes for use with snap-in cage nuts shall be provided for fixation of the equipment. The finishing shall be done in a textured black powder coating (RAL9004) color and have printed unit measurement indicators. The base angle profiles shall be mountable in outwards position for increased stability or inwards position for conserve floor space.

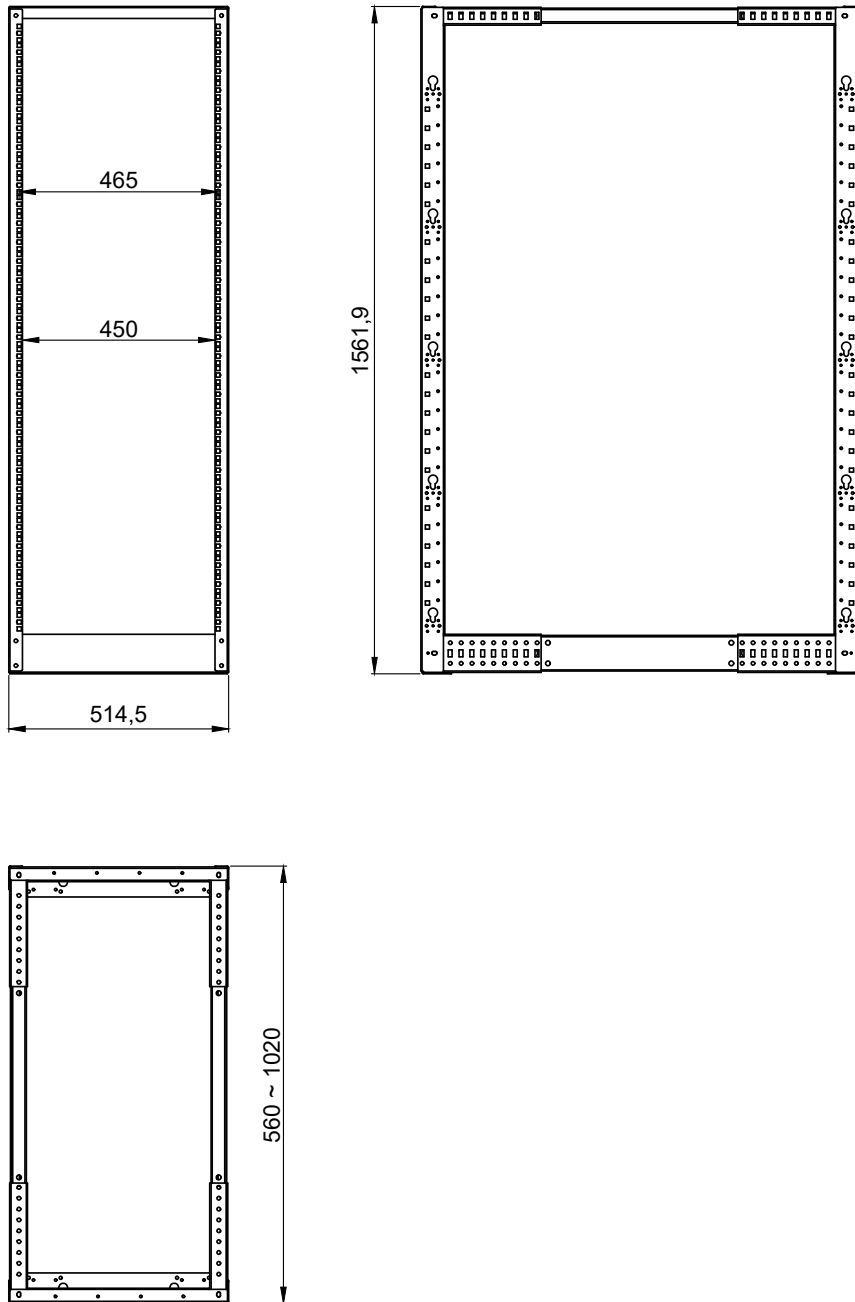

	DPR932		Product description: 4-POST OPEN FRAME 19" RACK - 32 UNIT - 550~950MM	
	Weight: 20,53 kg	Outer dimensions: (w x h x d) 514,5 x 1561,9 x 560 ~ 1020	Unit height: 32 HE	