

# Avtek Charging Cart

- Designed for simultaneous storage and charging of
- laptops or other mobile devices (maximum number of devices depends on the model - 16, 20 or 30).
- Intelligent sequential charging in groups,
- limiting the load on the electrical installation and extending the life of the power supplies.
- Built-in electrical safety features (including short-circuit, overvoltage, overload and leakage protection) and active cooling for safe operation.
- 

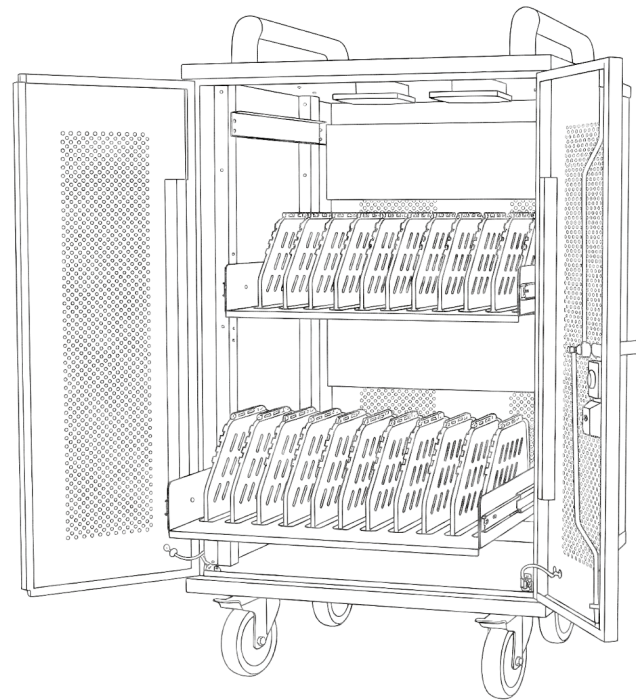

## Package contents

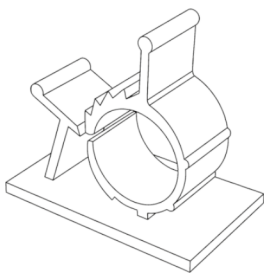

Self-adhesive cable holder

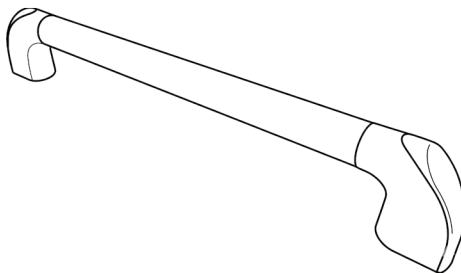

Handle

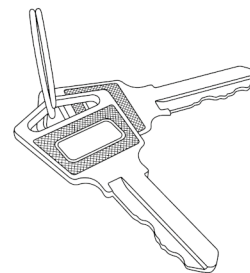

Set of keys for the lock

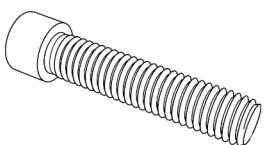

M10 × 45 mm screw

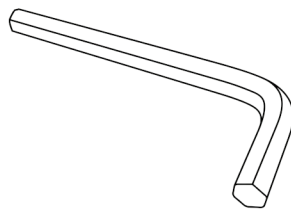

8 mm Allen key

## INTRODUCTION

Thank you for choosing an Avtek Charging Cart for storing and charging your devices.

To ensure safe use of the device and to take full advantage of its capabilities, please read this user manual before using the cart for the first time.

Before use, please:

- read the entire user manual carefully,
- follow all safety warnings and recommendations,
- use the device only as described in this manual,
- keep the manual for future reference,
- include the manual with the cart if you transfer it to another user.

The user manual is an integral part of the product.

## WARNINGS

### Placing the cart

- Place the cart on a stable, level surface.
- Do not place the cart near heat sources, in damp places or outdoors.
- Ensure free air flow around the cart – do not cover the ventilation openings.
- Lock the wheels when charging and inserting/removing devices.
- Do not allow the cart to tilt or place any weight on the open door – there is a risk of tipping and damaging the equipment.

### Power supply

- Only connect the cart to a properly earthed mains socket with the correct voltage.
- The power socket should be easily accessible so that the device can be quickly disconnected from the power supply if necessary.
- Do not use a damaged power cord or plug. If damaged, disconnect the cart from the mains and contact the service department.
- Do not use splitters, extension cords or power strips with unknown specifications or insufficient load capacity – risk of overheating and fire.
- Do not pull the cart by the power cord or pull the plug out by pulling on the cable – always grasp the body of the plug.
- Do not touch the plug or power cord with wet hands.

### Charging devices

- Only use power supplies and cables that are suitable for the devices being charged.
- Do not exceed the maximum number of devices and maximum load specified in the cart's technical data.
- Arrange the devices so that they do not press on the cables or block the ventilation openings.
- Do not place wet devices, devices with damaged batteries or devices whose technical condition may pose a risk of electric shock, overheating or fire inside the cart.
- Keep cables tidy; avoid cutting cables with the door and the risk of entanglement when pulling out shelves.
- Do not cover devices and power supplies with insulating materials – risk of overheating.

### Moving the cart

- Take extra caution when moving the cart.
- Before moving the cart, disconnect the power cord from the socket and from the cart, then secure the cable.
- Always unlock the wheels before moving the cart and lock them again after placing it in its new location.
- Push the cart using the handles provided – do not pull on the door or power cord.
- Do not transport the cart on stairs or uneven surfaces – this may damage the cart and equipment being transported.

### Temperature and operating environment

- Only use the cart within the temperature and humidity ranges specified in the manual.
- Do not expose the cart to direct sunlight, rain, snow or high humidity.
- Do not use the cart in a dusty environment or in an atmosphere where there is a risk of explosion.

### Children and unauthorised persons

- The cart is intended for use by trained personnel.
- Do not allow children to play with the cart or use it as a toy or means of transport.
- Do not transport people on the cart and do not sit on it.

### Maintenance and cleaning

- Always disconnect the cart from the power supply before cleaning.
- Clean the housing with a soft, slightly damp cloth; clean the interior of the cabinet and the areas around the electrical components with a dry cloth only. Do not use aggressive chemicals or solvents.
- Regularly check the condition of the power cord, plug, wheels and door lock.
- Do not clean the cart with pressurised water or immerse any part of it in water.

### Service and modifications

- Have all repairs and electrical inspections carried out by an authorised service centre only.
- Do not modify the design or wiring of the cart yourself – this may void the warranty and pose a safety hazard.
- If you smell burning, see smoke, sparks or hear unusual noises, immediately disconnect the cart from the mains and contact the service centre.

## LIMITATION OF LIABILITY

The occurrence of any of the following circumstances releases the manufacturer from warranty liability and the resulting obligation to repair the device free of charge:

- A. Damage to the product caused by failure to follow the user manual.
- B. Physical damage to the device caused by improper installation.
- C. Damage to the product resulting from modifications or repairs made without the manufacturer's consent.
- D. Damage to the product caused by using it in an environment where it should not be used.
- E. Damage to the product caused by excessive external forces.
- F. Damage to the product caused by natural disasters or other factors considered force majeure.
- G. Broken or damaged warranty seals.
- H. Lack of acceptable proof of purchase.

## PACKAGE CONTENTS

Model and product name	Avtek Charging Cart 16 Server	Avtek Charging Cart 20	Avtek Charging Cart 30
Avtek Charging Cart	✓	✓	✓
Handle	2 pieces	2 pieces	2 pieces
Set of keys for the lock	2 pieces	2 pieces	2 pieces
M10 × 45 mm screw	4 pieces	4 pieces	4 pieces
8 mm Allen key	1 piece	1 piece	1 piece
Self-adhesive cable holder	30 pieces	30 pieces	30 pieces
User manual	✓	✓	✓

SPECIFICATION			
Model and product name	Avtek Charging Cart 16 Server	Avtek Charging Cart 20	Avtek Charging Cart 30
Capacity	16 devices + additional compartment for server/UPS/printer	20 devices	30 devices
Device compartment dimensions (W×D×H):			
• top shelf	36 × 330 × 380 mm	40 × 330 × 350 mm	40 × 330 × 380 mm
• additional compartment/ bottom shelf	450 × 450 × 410 mm	40 × 330 × 350 mm	40 × 330 × 350 mm
Product dimensions (W×D×H)	660 × 820 × 1060 mm	600 × 660 × 1010 mm	660 × 820 × 1060 mm
Net weight	71.4 kg	59.5 kg	72.4 kg
Packaging dimensions (W×D×H)	720 × 880 × 1100 mm	660 × 720 × 1050 mm	720 × 880 × 1100 mm
Gross weight	74 kg	61.5 kg	75 kg
Main material	Steel (SPCC)	Steel (SPCC)	Steel (SPCC)
Case color	Black	Black	Black
Compartment colour	Blue	Blue	Blue
Input voltage	AC 110-250V	AC 110-250V	AC 110-250V
Output (sockets)	AC 110-250V, 50/60HZ, 16A	AC 110-250V, 50/60HZ, 16A	AC 110-250V, 50/60HZ, 16A
Charging type	Sequential	Sequential	Sequential
Charging section division	4 sections with 4 sockets each	5 sections with 4 sockets each	6 sections with 5 sockets each
Operating temperature range	0°C~45°C	0°C~45°C	0°C~45°C
Operating humidity range	20%~80%	20%~80%	20%~80%
Cooling	✓	✓	✓
Status indicator lights	✓	✓	✓
Lightning protection	✓	✓	✓
Overload protection	✓	✓	✓
Puncture protection	✓	✓	✓
Short circuit protection	✓	✓	✓
Overcharge protection	✓	✓	✓
Lockable wheels	✓	✓	✓

## SERVICE AND CHARGING

### Preparing for use

- Place the cart on a stable, level surface and lock the wheels.
- Ensure that the doors, compartments, handles and power cord are undamaged.
- Check that there is an easily accessible, properly earthed 230 V AC socket near the cart.

### Placing devices

- Open the cart doors. Pull out the shelves, if the model has them.
- Place laptops, tablets or other electrical devices in the compartments so that they are stable and do not press on the cables.
- Connect the power supplies of the devices to the sockets in the cart and the plugs to the devices.
- Route the cables so that they are not cut by the doors and do not get tangled when the shelves are pulled out.
- In the Avtek Charging Cart 16 Server model, place additional devices (e.g., server, UPS, printer) in a separate compartment.

### Connecting the cart to the power supply

- Ensure that all devices are properly connected.
- Insert the power cord plug into the cart's socket.
- Then connect the power cord to the mains socket.

### Sequential charging of devices

- The charging sockets are divided into several sections (see the "Specifications" section – "Division into charging sections").
- One section is charged at a time. After approximately 5 minutes, the cart automatically switches charging to the next section.
- Once the cycle of all sections is complete, charging returns to the first section.
- Sections with no devices connected may be automatically skipped.
- This mode of operation reduces the momentary load on the electrical system and increases the service life of the power supplies.

### Charging status indicators

- Each socket or section has a light indicating the cart's operating status (the exact location of the indicators depends on the model):
  - light off – no device connected or charging not active,
  - red light – device is charging,
  - green light – device charging is complete,
  - flashing red light – overload or charging error; disconnect the device and check its power supply unit.

### Finishing work

- Once charging is complete, you can leave the devices inside the cart or remove them.
- Before moving the cart:
  - remove the power cord plug from the mains socket,
  - disconnect the cord from the cart socket and secure it.
- Close the door and lock it with a key if necessary.

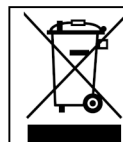

Correct disposal of the product (regulations on waste electrical and electronic equipment) (applies to countries using separate waste collection systems). This marking on the product, accessories or in the manual indicates that the product and its electronic accessories (e.g., charger, headset, USB cable) must not be disposed of with household waste at the end of their service life. To avoid environmental contamination or health risks caused by improper disposal, separate these items from other waste and dispose of them responsibly to enable reuse of materials. Household users should contact the product seller or local authorities for information about where and how to dispose of these products safely. Institutional users should contact their supplier and check the terms of the purchase agreement. The product and its electronic accessories must not be disposed of with other commercial waste.